

INSTALLATION INSTRUCTION REMOTE CONTROLLER



2 YEARS WARRANTY

TECHNICAL DATA:

MODEL	VT-2438
INPUT VOLTAGE	3V (AAA x 2PCS) (BATTERY NOT INCLUDED)
TRANSMISSION POWER	6dBm
STANDBY POWER CONSUMPTION	15µA
TRANSMISSION FREQUENCY	2.4GHz
DIMENSION	47x19x153mm

INTRODUCTION & WARRANTY

Thank you for selecting and buying V-TAC product. V-TAC will serve you the best. Please read these instructions carefully before starting the installation and keep this manual handy for future reference. If you have any another query, please contact our dealer or local vendor from whom you have purchased the product. They are trained and ready to serve you at the best. The warranty is valid for 2 years from the date of purchase. The warranty does not apply to damage caused by incorrect installation or abnormal wear and tear. The company gives no warranty against damage to any surface due to incorrect removal and installation of the product. The products are suitable for 10-12 Hours Daily operation. Usage of product for 24 Hours a day would void the warranty. This product is warranted for manufacturing defects only.

WARNING!

1. For Indoor use only
2. In the using of the remote, if the indicated lamp blinking quickly, pls change the battery in time. Pls don't use poor quality battery to avoid the leaking of battery liquid to damage the remote.
3. Pls don't use the remote on the wide-range metal or strong electromagnetic wave area, otherwise, it will badly affect the controlling distance.

**IN CASE OF ANY QUERY/ISSUE WITH THE PRODUCT, PLEASE REACH OUT TO US AT: SUPPORT@V-TAC.EU
FOR MORE PRODUCTS RANGE, INQUIRY PLEASE CONTACT OUR DISTRIBUTOR OR NEAREST
DEALERS. V-TAC EUROPE LTD. BULGARIA, PLOVDIV 4000, BUL.L.KARAVELOW 9B**

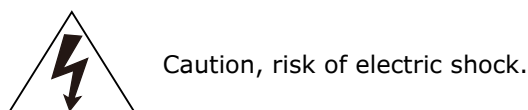
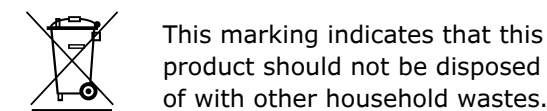

PRODUCT KEY DIAGRAM

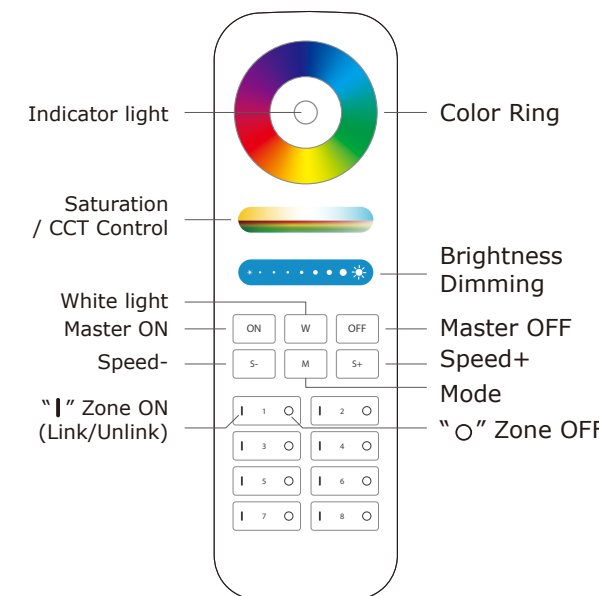

FEATURES

- Touch the color ring to change colors.
- Under white light mode, adjust color temperature; Under color light mode, change color saturation.
- Slide the brightness slider to adjust the brightness.
- Press the button to get white light.
- Touch ON button, turn on the linked device.
- Touch OFF button, turn off the linked device.
- Dynamic mode switching button.
- Lower the dynamic mode speed.
- Accelerate the dynamic mode speed.

LINKING & UNLINKING

Remark: The light can be working after linking with the remote.

LINKING INSTRUCTIONS

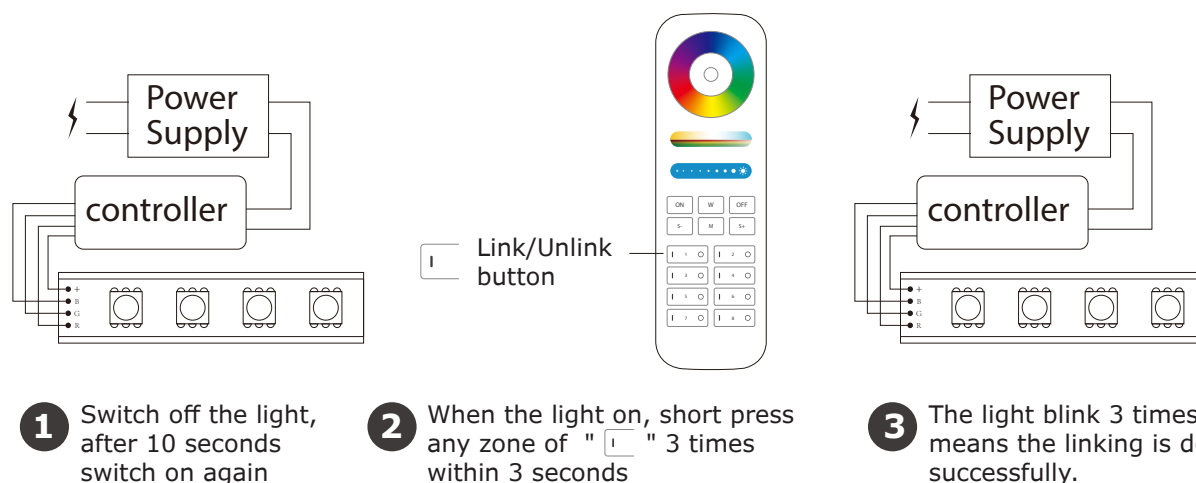

If the light not blink slowly, the linking failed, Pls switch off the light again, and follow the above steps again.



MULTI-LANGUAGE MANUAL QR CODE

Please scan the QR code to access the manual in multiple languages.

UNLINKING INSTRUCTIONS

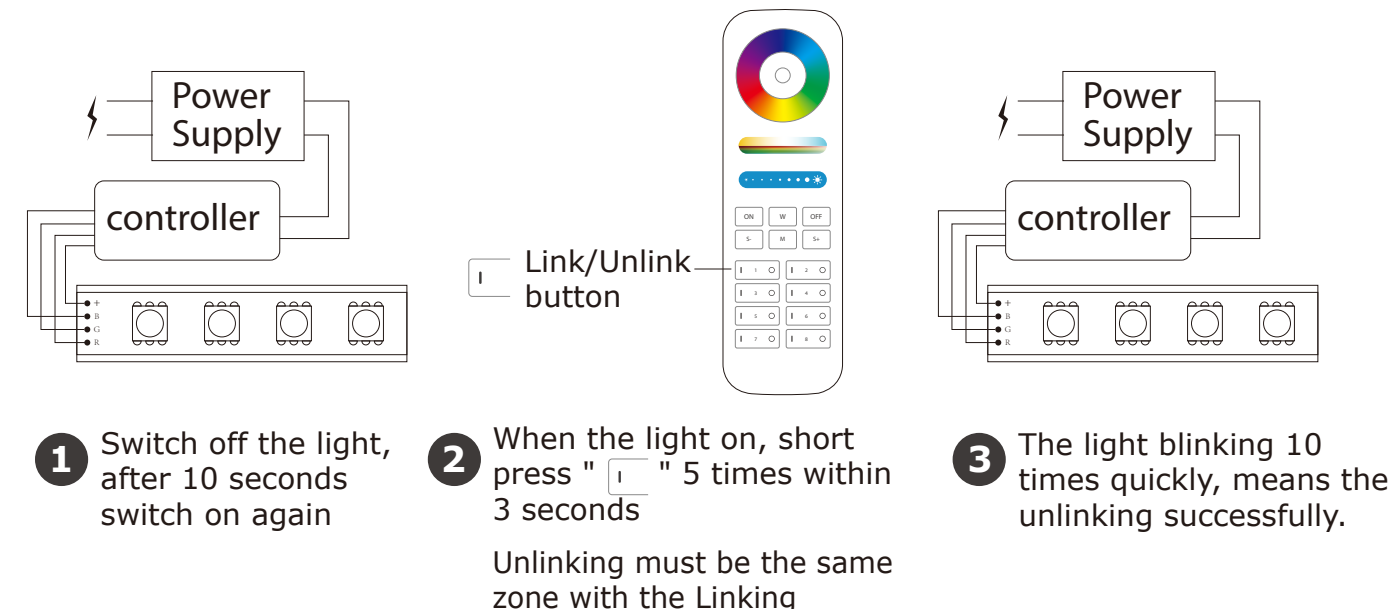

If the light not blink quickly, the unlink failed, pls switch off the light again, and follow the above steps to unlink again.

Grouping of several lights

You can add an endless numbers of lights to a zone on the 8 channel remote by linking the lights to different zones. This way you are completely flexible in creating different group combinations. Below you can see some grouping examples.

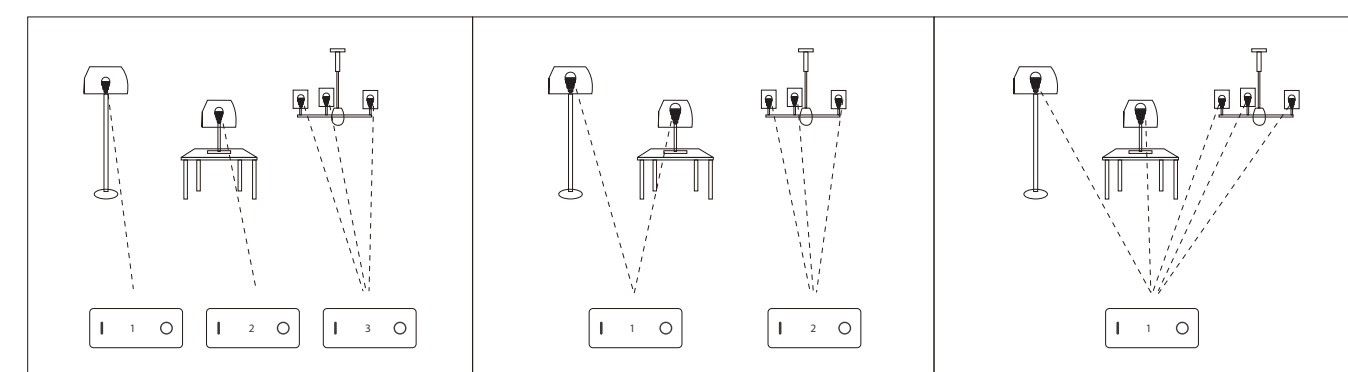

Remark:

1. The user can re-programme freely as needed. One remote can control countless lamps or controllers, but one lamp or controller can only be controlled by four remotes (Max).
2. Please check the battery installation and controller (totally discharge the power), when you programme after switching off and switching on.

COMPATIBLE DEVICES

Compatible with the below devices (Not included; available to buy separately)

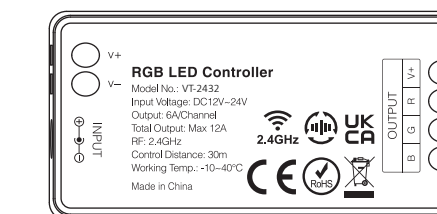

(SKU: 2912
VT-2432)
(NOT INCLUDED)

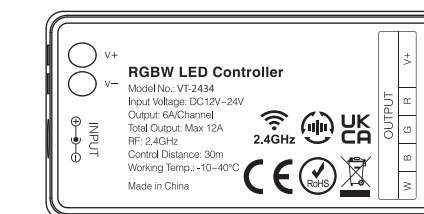

(SKU: 2913
VT-2434)
(NOT INCLUDED)