

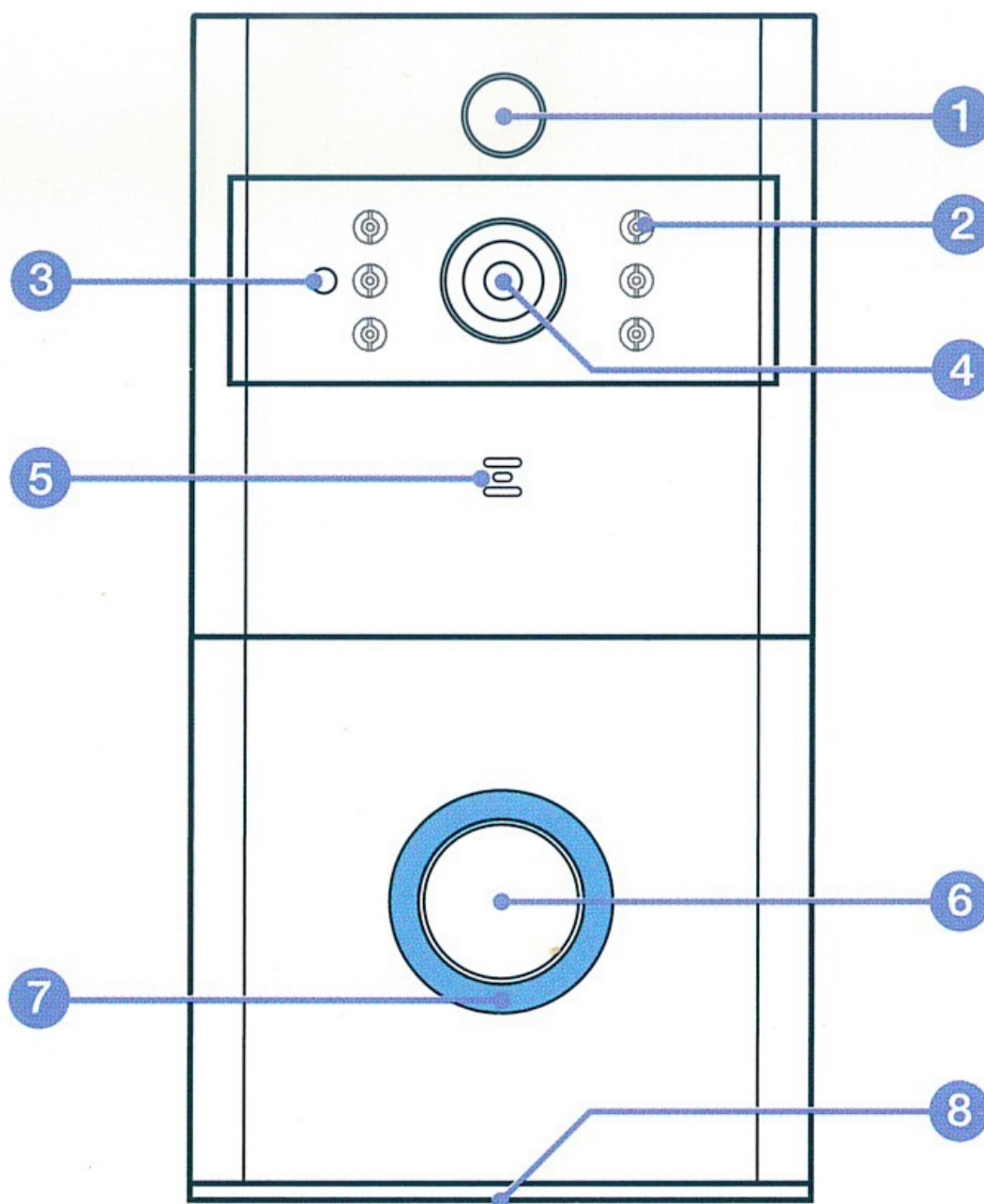

Model No:VT-5412
SKU:8355

1. Product Drawing - Front



1. PIR Motion Sensor

2. Infrared LED × 6

3. Light Sensor

4. 166° HD Camera

5. Microphone

6. Push Button

7. Indicating LED

8. Speakers

2. Product Drawing - Back

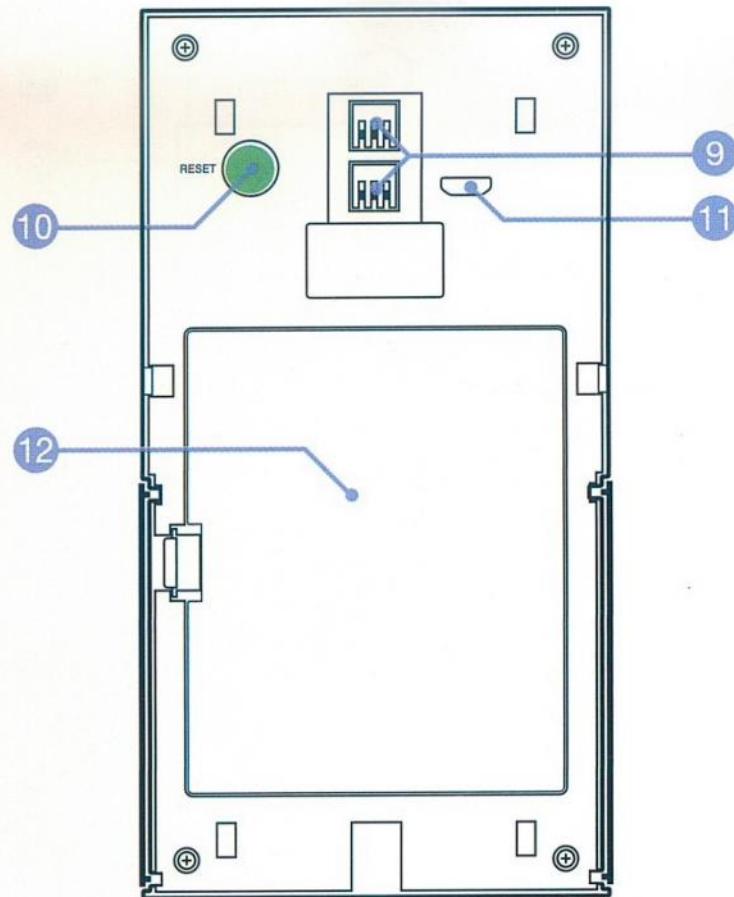

- 9. AC14V~24V Power Interface
- 10. Reset Button
- 11. Micro USB Port (Battery Charging)
- 12. Battery Compartment Cover

3. Product Drawing - Mounting Bracket

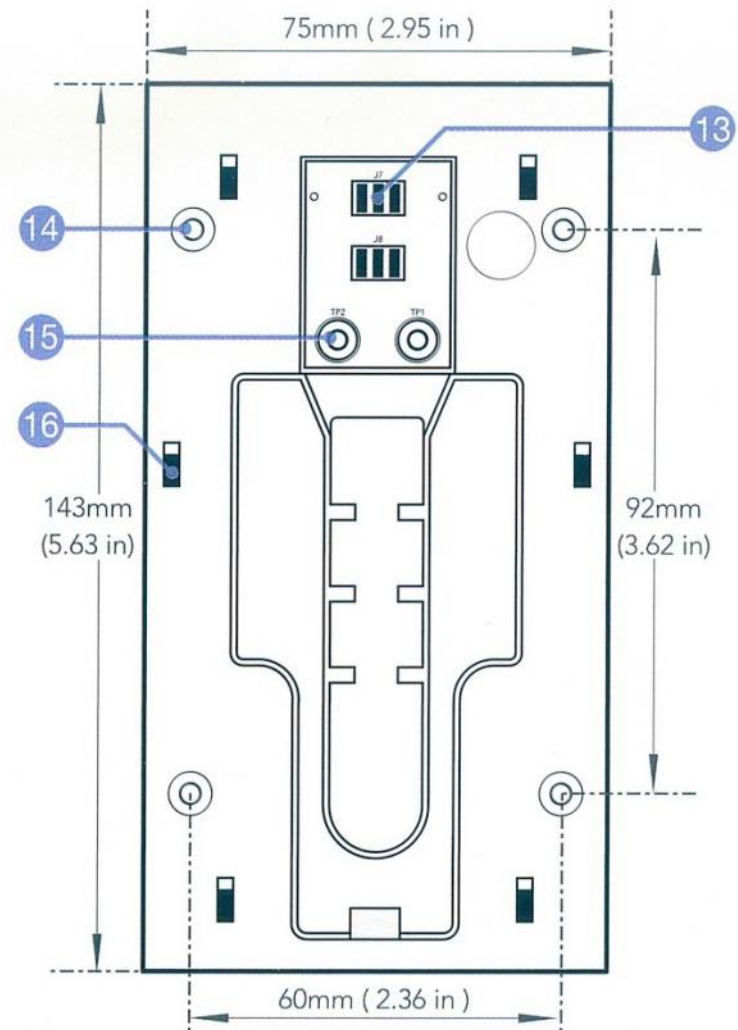

- 13. Power Contact Base
- 14. Screw Holes x 4
- 15. Wire Terminals
- 16. Mounting Hooks x 6

4. Installation -Bracket Install

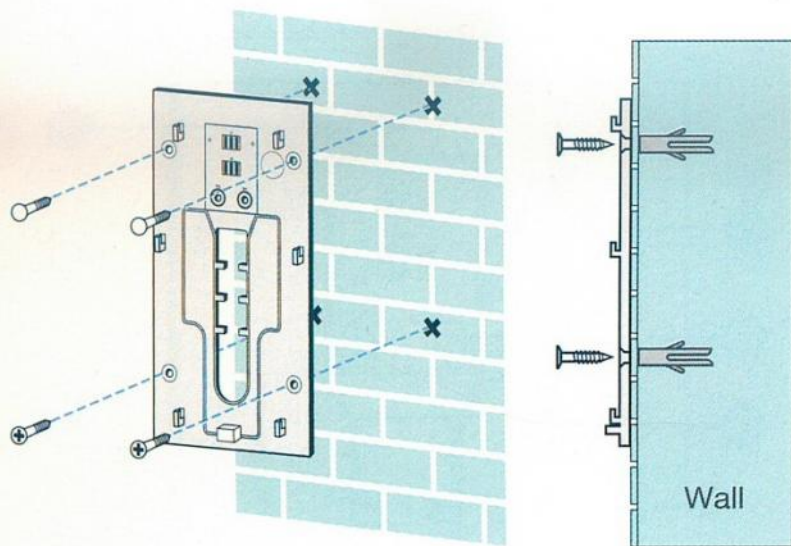

② Seal Tightly

③ Tighten to secure

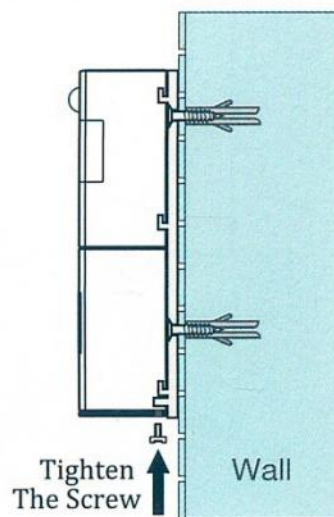
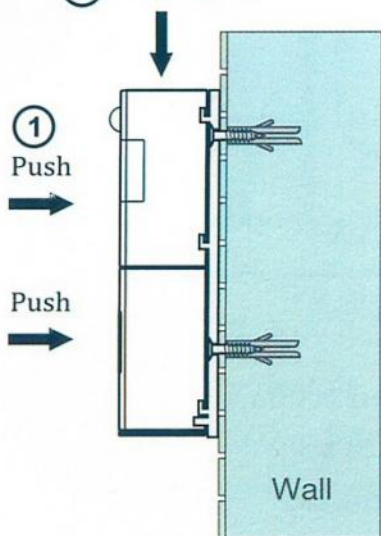

5. Power Supply Solution

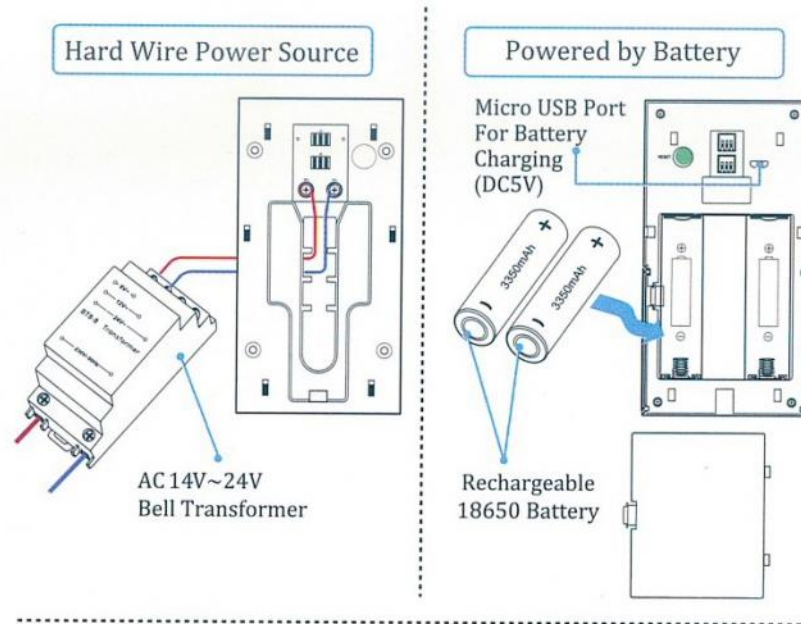

6. App Download - VTAC SMART LIGHT

Scan to download the App



V-TAC Smart Light

Download the app from App Store or Google Play, run the app on your smart phone, and set up the smart video doorbell, following the app instructions.

7. Smart WiFi Video Doorbell Parameter:

Smart WiFi Video Doorbell security solution mainly provides the following functions: wireless connection, ultra-low power consumption, remote active wake-up, quick start

Main Processor	Hi3518E
Sensor	1/4 COMS OV9732
Video	1280*720@25fps
	H.264 Bitrate self-adaptive
	Suitable for changeable network environments(3G,4G or WIFI)
Audio	Two-way voice & Support echo cancellation
	Built-in speaker
	Built-in Microphone
View Angle	166 degree Horizontal
Day & Night	IR-CUT double filter automatically switches
	6pcs infrared LED 850mm
	Min Illumination:1 Lux
Connection	Support WiFi 2.4 GHz, IEEE 802.11 b/g/n
	AP Hot spot
	Scan QR code
Storage	Support SD card 8G / 16G / 32G
Recording	Support smart phone local record, records video playback
	Optional recording time setting between 15s -45s, once doorbell triggered
Screen Shot	Support Smart phone screen shots
Working Condition	Press Button Directly
	PIR detection triggered
	Mobile phone Control
Running up	System running up in millisecond
Inform	Push message within 1s-2s
Motion Detection	PIR motion detection, sensitivity High(2s)/ Medium(within 5s)/ Low (within 10 s)
Scene Mode	Backlight compensation
	Infrared night vision
	Quick movement
	HLC
	D-WDR
Share	Support QR code share(one-click generates QR-code, share to others To add your doorbell devices, join in remote control. Maximum supports 7 authenticated users, supports users 3 view at the same time
Battery	3.7V, 2pcs 18650 battery, 3350mAH, Rechargeable or (14V~24V AC charging)
Power Consumption	Working 170mA, Standby 160μA

8. Apk main functions

Smart life apk integrates low-power smart security solutions Tuya , which provide the following management functions for video doorbells:

1. Smart doorbell management functions, including adding and deleting doorbells.
2. Configure the smart doorbell connection through WiFi network on apk.
3. Receive push messages, including doorbell call and motion detection (PIR) and push information management function.
4. Connect the video doorbell, view the camera through the doorbell, screenshot and local recording function.
5. Smart doorbell user management function can share the video to other family members.
6. Smart doorbell setting functions, including power management settings, basic function settings, motion detection settings, memory card settings, software upgrades.

Version support:

1. Android apk only supports Android 4.1 and above operating systems;
2. IOS apk supports IOS8.0 and above operating systems

9. Apk Guide

Download V-TAC Smart Light.apk on mobile phone, open apk, you can see the following guide page.



10. User Register

New user register it according to guide steps,already registered user just login it.

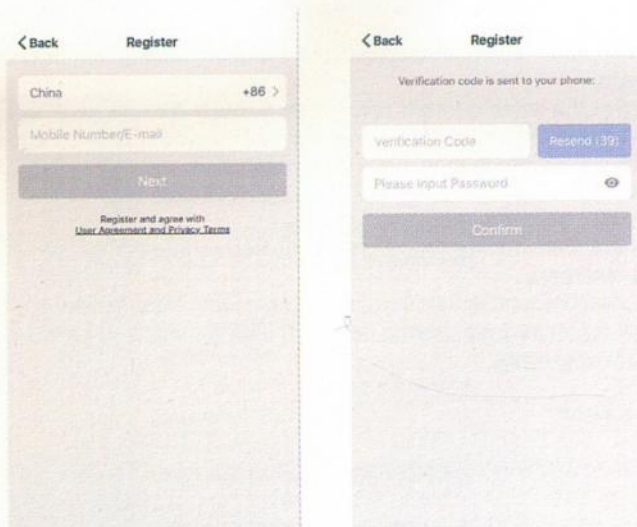

11. Add Device

Select device type: Security camera. Then make connection with the device according to the steps

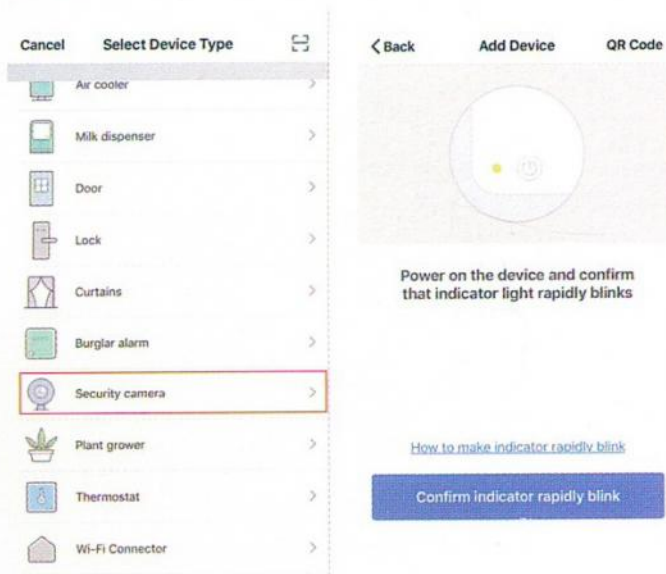

11.1 General Connection

Power on the device and confirm that indicator light rapidly blinks.(red light blink per 1s),

click"Confirm indicator rapidly blink", Enter Wi-Fi Password and Confirm; waiting for device connection till success.device will show blue light blink always, name the doorbell.

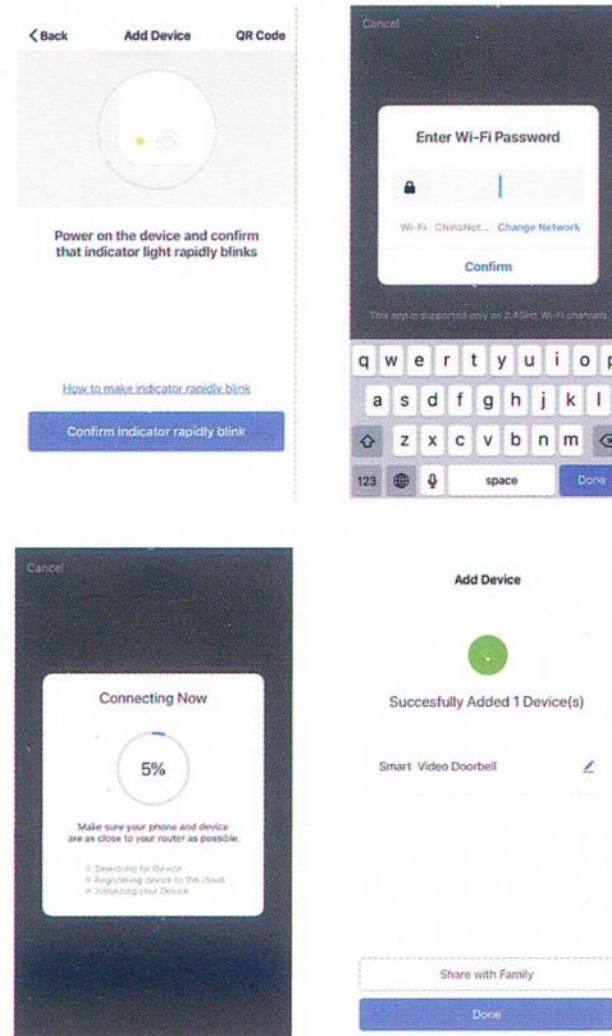

11.2 QR Code Connection

Power on the device and click "QR Code", confirm that indicator light rapidly blinks. (red light blink per 1s),

Enter Wi-Fi Password and Confirm, it generates QR Code, scan it and waiting for device connection till success. device will show blue light blink always, name the doorbell.

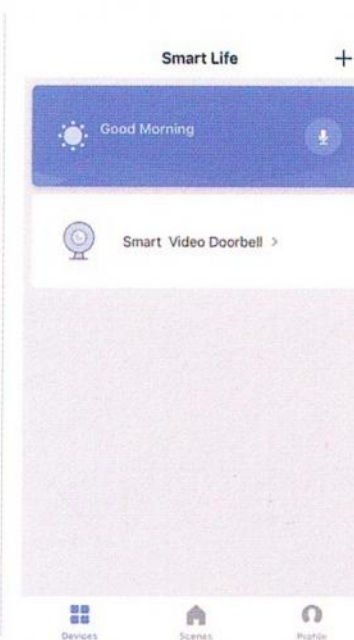
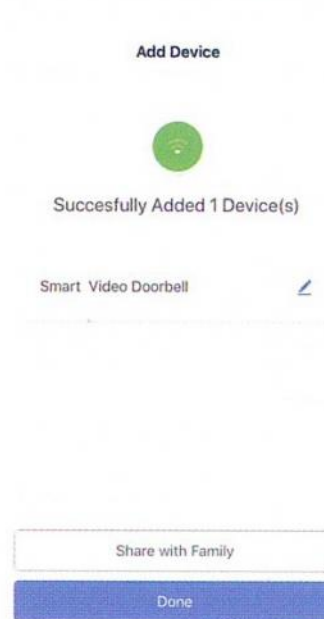
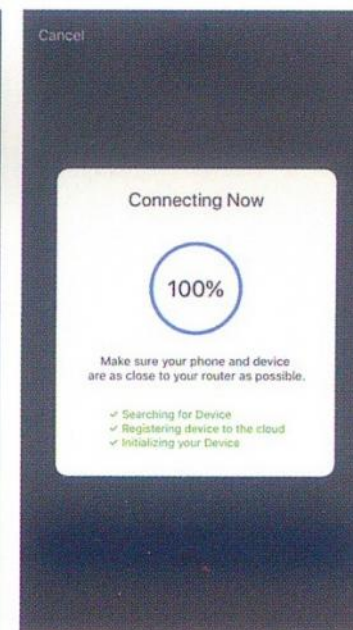
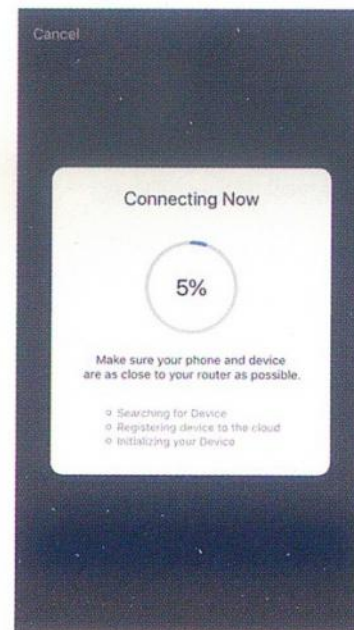

Device connection status description:

1.The red light is blinking always.

➤ Ready to connect network mode, after a few seconds of waiting, with tone reminder.

2.Flashing red, 1s blinks once.

➤ The device has entered the network connection mode. If the device successfully receives the broadcast or detects QR Code, with prompt tone reminder.

➤ If the device failed to enter connection mode,possibly: 1) The wifi router does not support broadcast transmission, suggest to change QR code mode for connection. 2) It may detect QR code failed, recommended to highlight the light of smartphone screen, put directly in front of doorbell lens.

3.The blue light is blinking always.

➤ The device has entered the connection mode.

➤ If the device failed to connect with network,possibly: 1) It may times out, configure the correct WiFi account but with wrong WiFi password, then device will stay unconnection status, suggest reconfigure the network. 2) Device has been bound by other users'smartphone, suggest delete the device and reconfigure the network.

4.The red light and blue light alternately blink once every 1s, device normal stadby mode. After wake up status, it still keep unchanged, device didn't enter connection mode.

5.The blue light blinks once every 1s, device normal stadby mode. After wake up status, it still keep unchanged, device enter connection mode properly.

12. Live View Descripton

12.1 Live View

Device list, it shows all devices with network connection.

Select device name to live view images directly. Support following functions: Two-way Audio; Video recording to local file; screenshot; playback video on TF card.

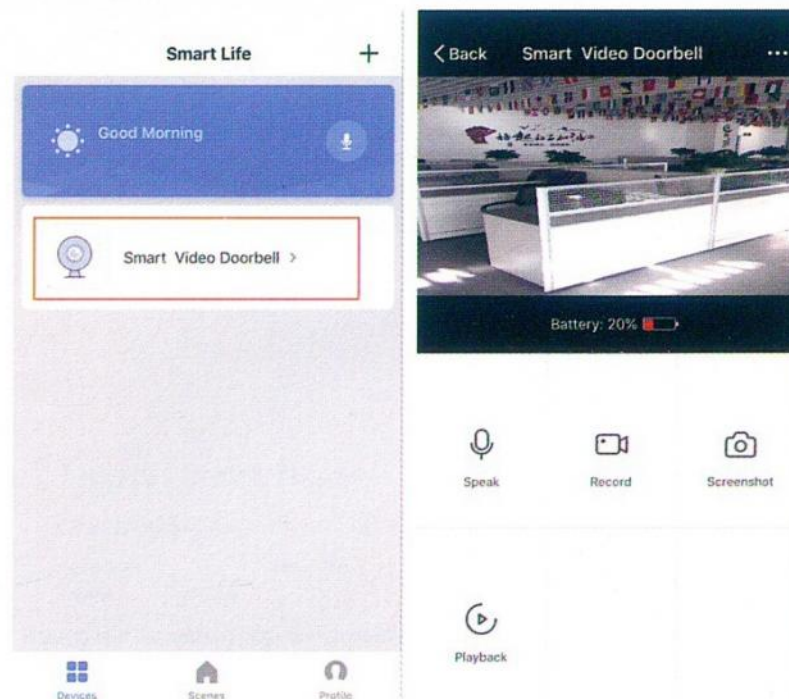

12.2 TF Card Video Playback

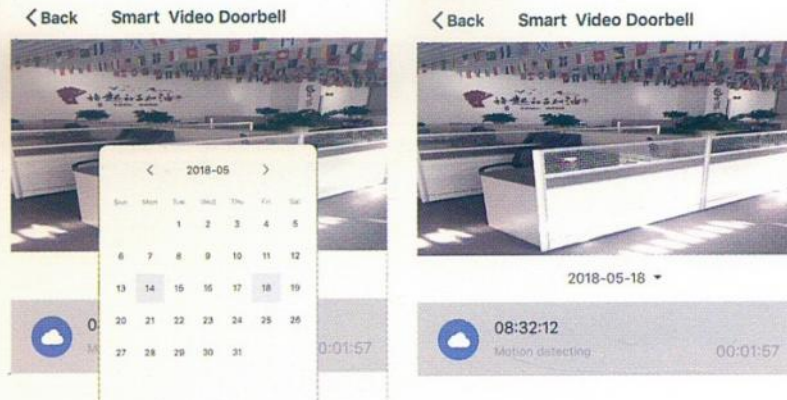

Video type icon description:

- 1.wake up the device and take video: smartphone app wakes up the device and recording.
- 2.Press button to wake up the device and take video: via Press the doorbell button, wake up the device and recording the device.
- 3.Motion detection and take video: Some people stay in front of the device or move will be detected, once it detects and recording.

TF card statement:

- 1.Currently the device only supports TF cards with the FAT32 system format, Others cannot be identified.

13. Device Management

Click "...on live view page to enter device management.

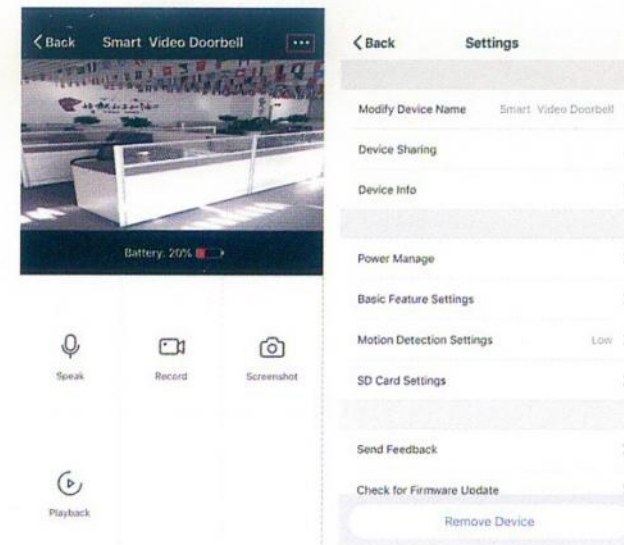

13.1 Modify Device Name

Click"Modify Device Name" on setting page to rename device.

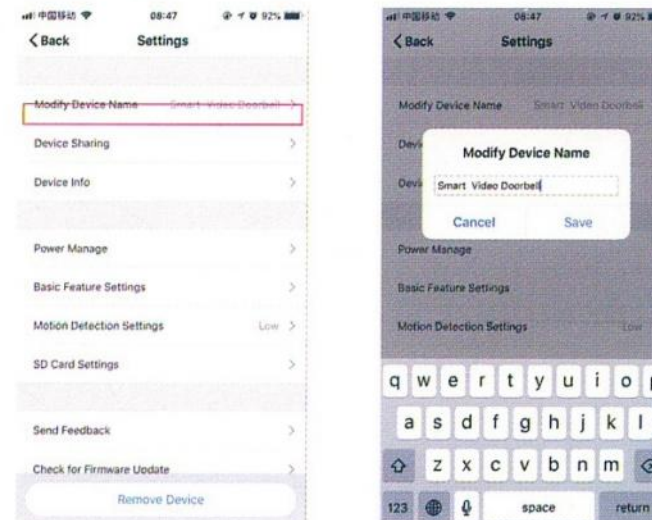

13.2 Device Sharing

Click "Device Sharing" on setting page to share other family members.

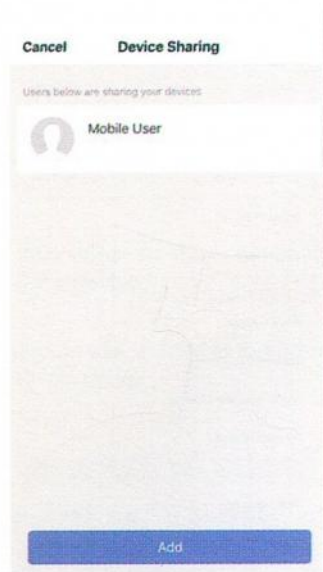
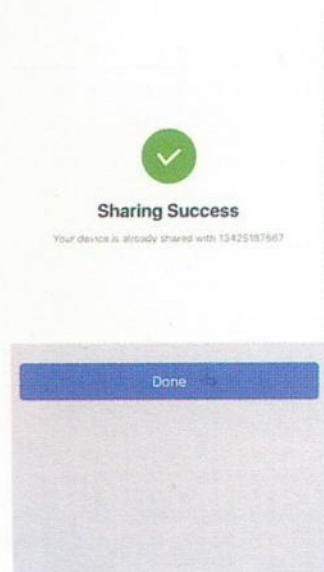

13.3 Device Info

Click " Device info" to check device information.

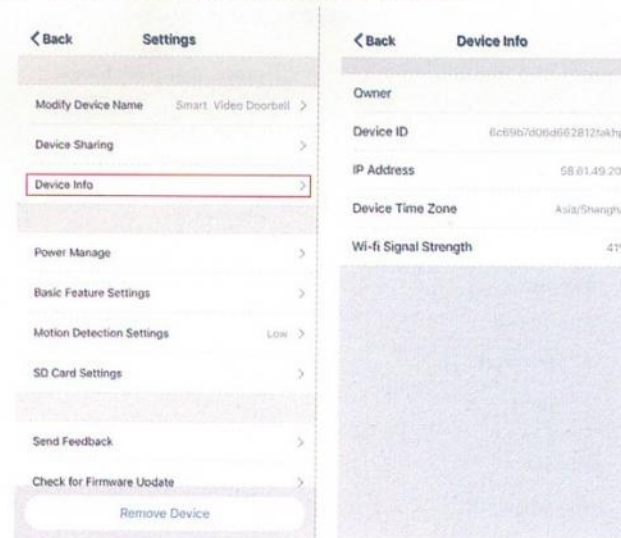

13.4 Power Management Setting

Click " Power Manage " to check power working status.

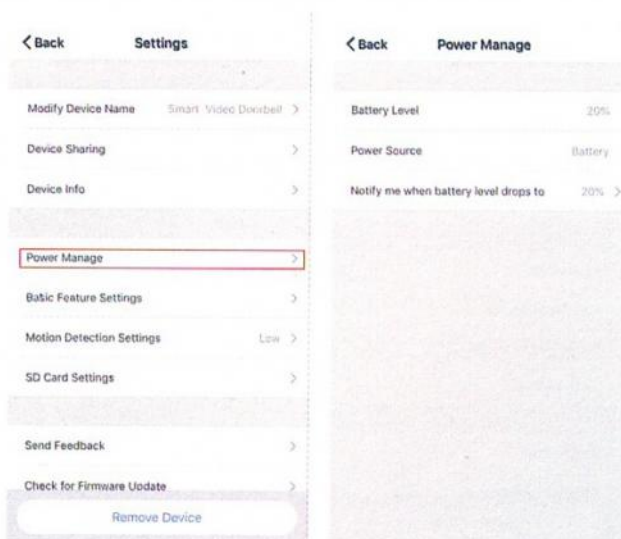

13.5 Basic Function Setting

Click "Basic Function Settings" to set below functions: Indicator status; image reverse; time watermark; wide dynamic mode; IR night vision.

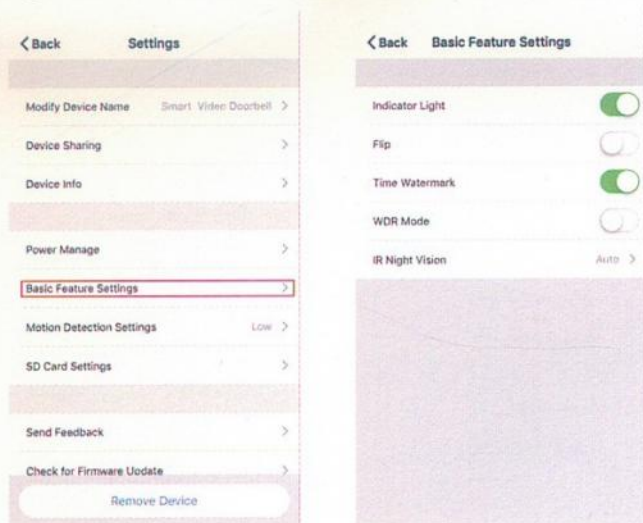

13.6 Motion Detection Setting

Click "Motion Detection Settings" to set the sensitivity.

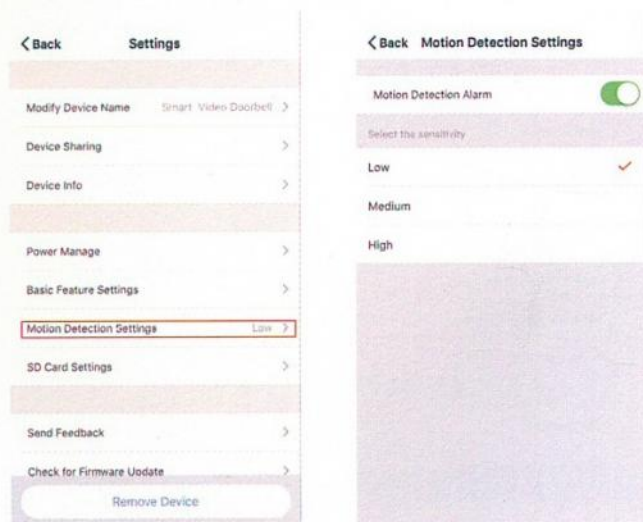

13.7 SD card setting

Click "SD card setting" to check SD card volume, setting SD recording take video or not, format memory card.

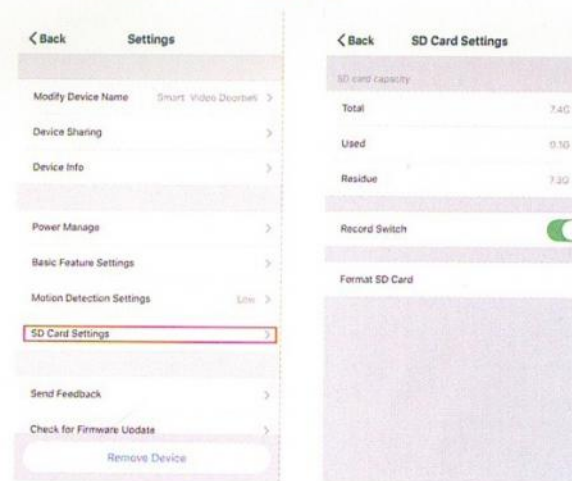

14. Apk receive push message

14.1 Doorbell call push message

Press doorbell and it rings, device make call to smartphone, select "Accept" to check the monitoring image or "Refuse" the call.

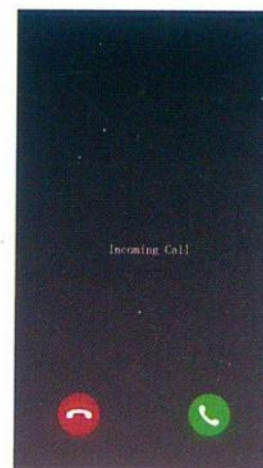

14.2 PIR Motion Detection Push Message

Select push message, some people stay in front of the device or move will be detected, once it detects and recording.

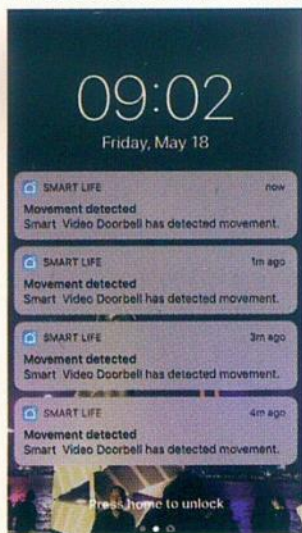

15. Message Center

Click app " Message Center" to check the history push message.

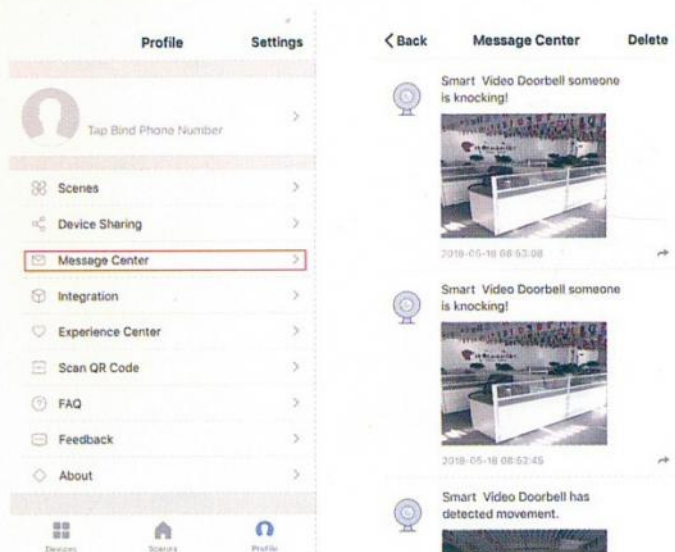

16. Setting

Click app" Setting" to set Sound, Push Notification etc

