

V-TAC

Meaningful Innovation.

WEEE Number: 80133970

MANUALE D'ISTRUZIONI

CAR PORT

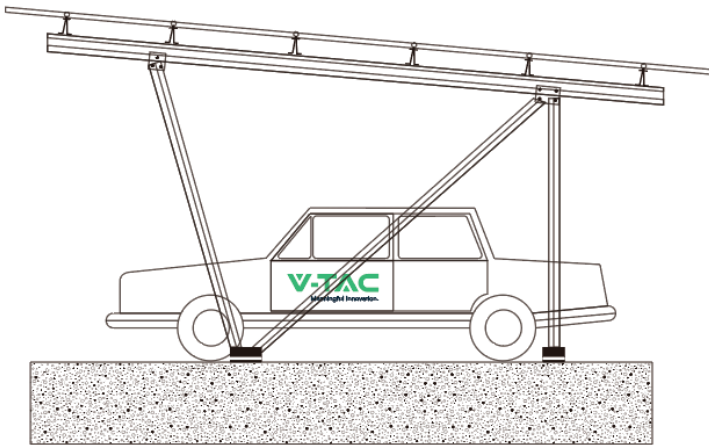

1. Disegno schematico

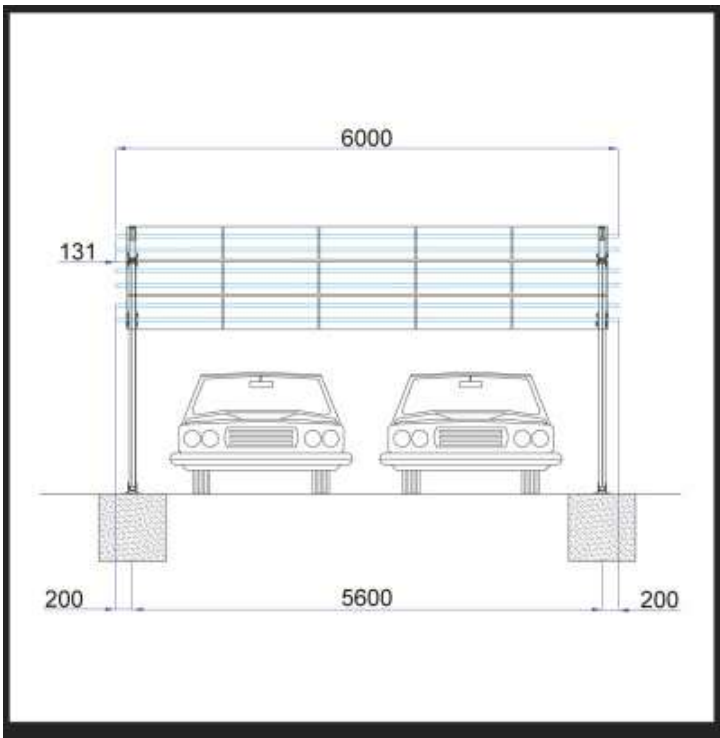
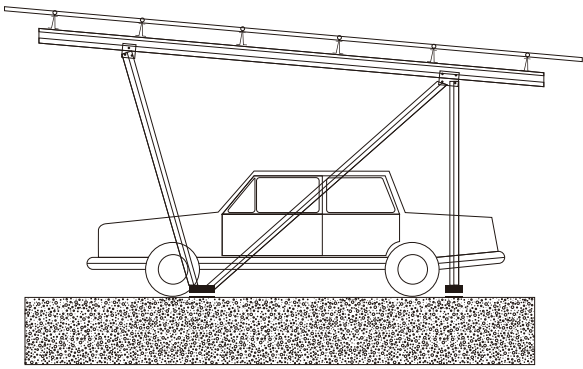

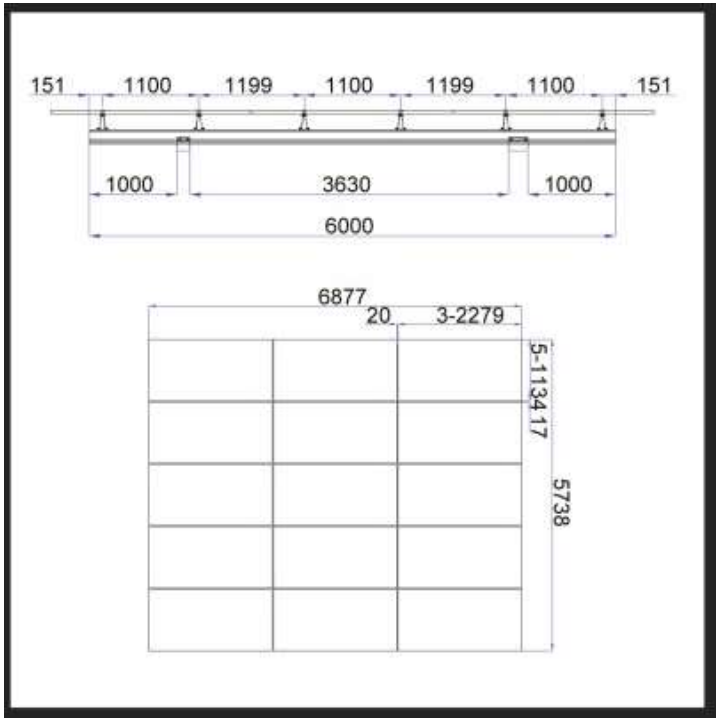
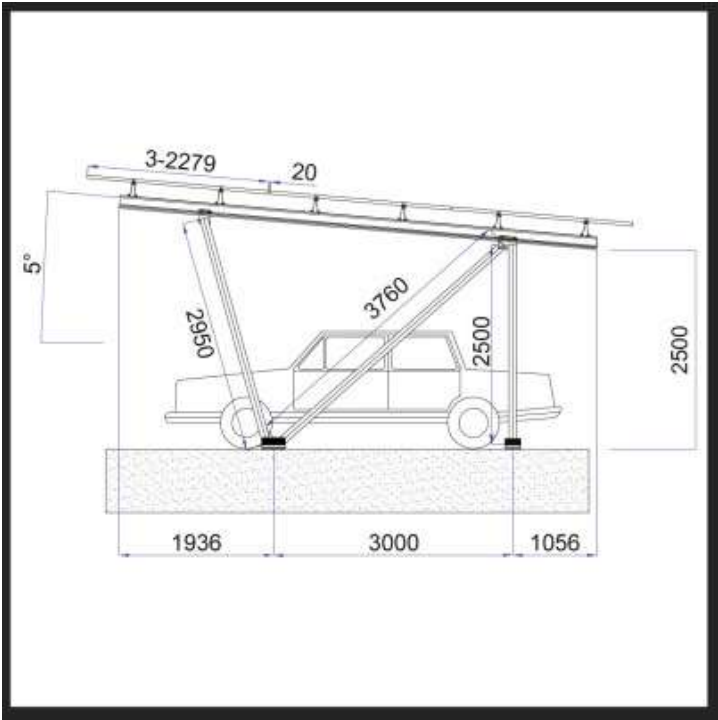

2. Elenco prodotti

SKU	Immagine	Descrizione	Qt.	Barcode
118211		Barra trasversale 5900 mm	6	3800170208384
118212		Kit di bloccaggio	48	3800170208391
118213		Morsetto medio 35 mm	24	3800170208407
118214		Terminale Morsetto 35mm	12	3800170208414
118215		Carport Stringer 6000mm	2	3800170208421
118216		H Jackets 150mm	2	3800170208438
118217		H Jackets 220mm	2	3800170208445
118218		Carport Tube 2500mm	2	3800170208452
118219		Carport Tube 3760mm	2	3800170208469
118220		Carport Tube 2950mm	2	3800170208476
118221		Base 200mm	2	3800170208483
118222		Base 300mm	2	3800170208490
118223		Accessori impermeabili	28m	3800170208506

3. Struttura del posto auto coperto

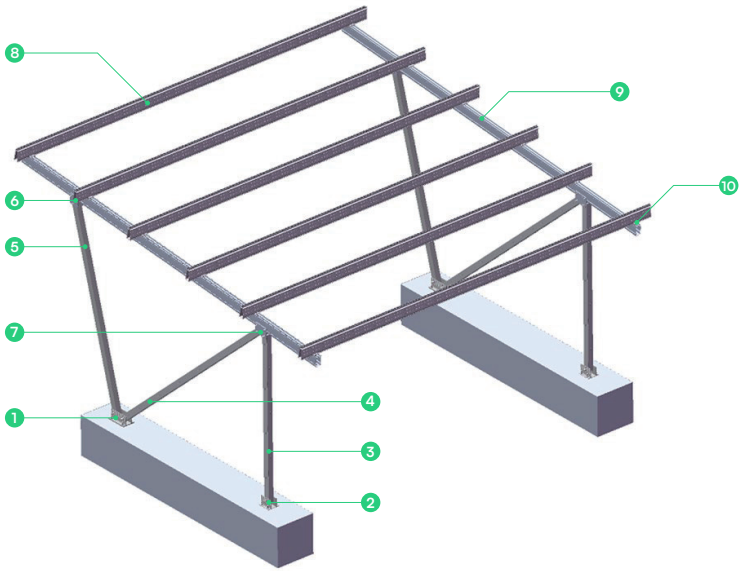

4. Accessori

1
Base
(300mm)



2
Base
(200mm)



3
Carport Tube
(2500mm)



4
Carport Tube
(3760mm)



5
Carport Tube
(2950mm)



6
H Jacket
(150mm)



7
H Jacket
(220mm)



8
Crossbar Rail
(5900mm)



9
Carport Stringer
(6000mm)



10
Clamping kit
(35mm)



Mid Clamp
(35mm)



End Clamp
(35mm)



5 . Fasi di installazione

Passo 1

Smontare le viti della base per fissarla a terra.

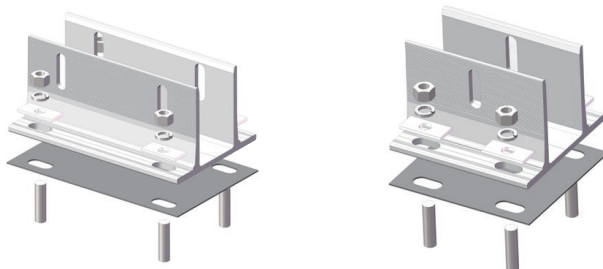

Passo 2

Usando le viti della base per fissare i tubi terminali del posto auto coperto, nel frattempo, fissare i rivestimenti ad H sulla traversa del posto auto coperto, quindi collegare i rivestimenti ad H con l'altra estremità dei tubi del posto auto coperto..

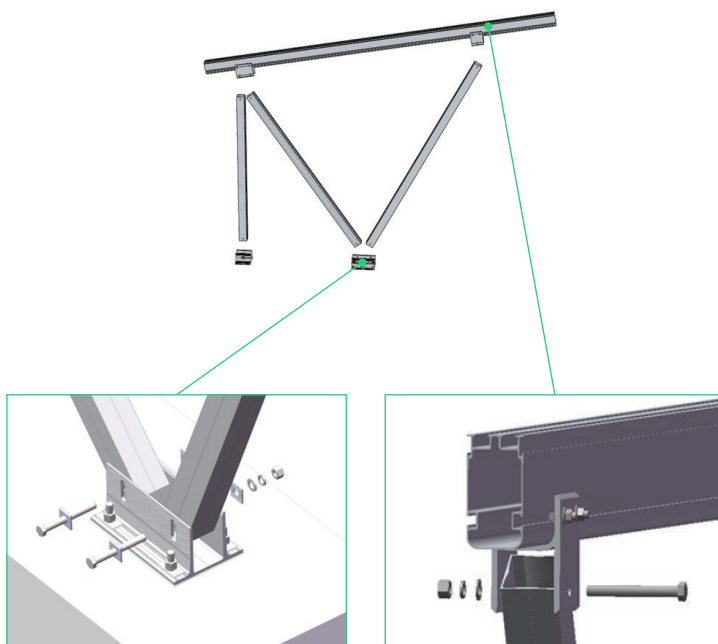

Passo 3

L'altro lato dovrebbe essere installato con lo stesso metodo.

Passo 4

Utilizzando il kit di bloccaggio per installare la barra trasversale e la traversa.

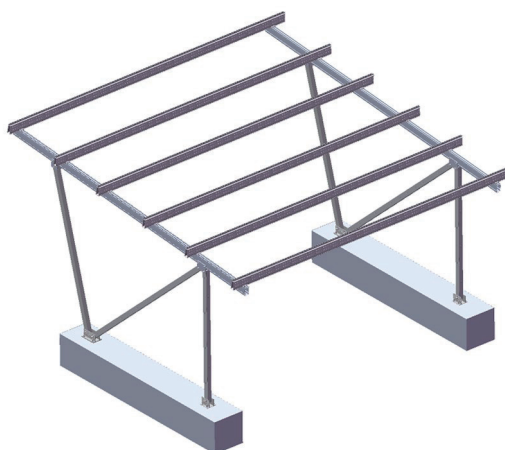
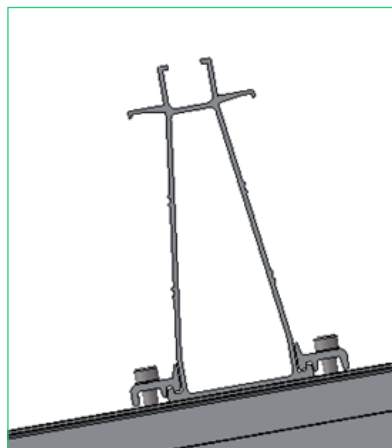
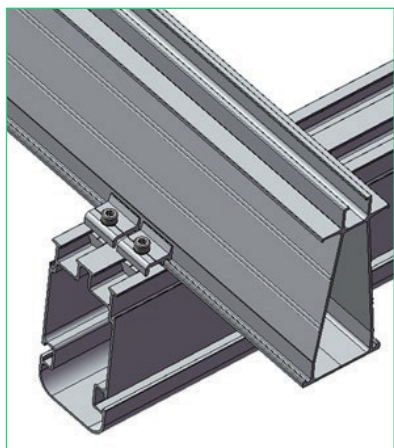
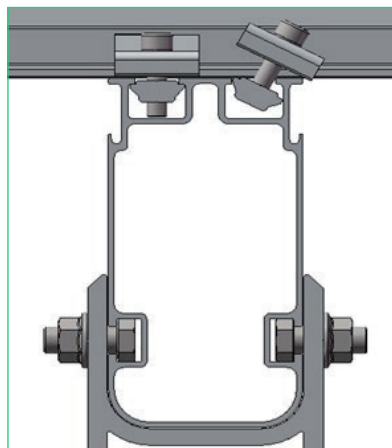
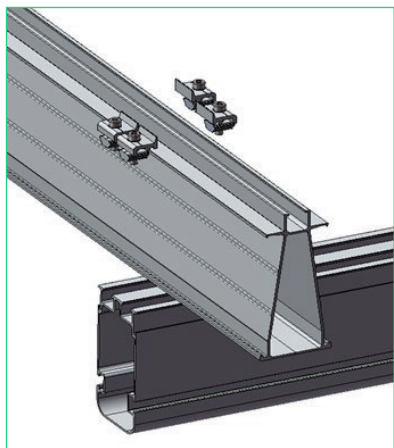

Passo 5

Utilizzo di morsetti centrali e terminali per fissare i pannelli solari sulla traversa.

